

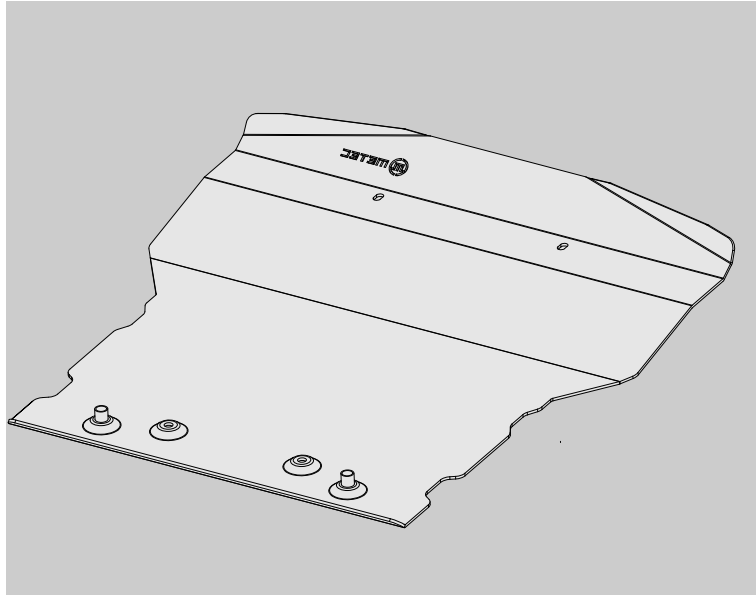

# MB Sprinter 2018-

Art. 818870

Põhjakaitse | Skid plate | Защита картера | Motorschutz



- |   |    |
|---|----|
| 1. Põhjakaitse / skid plate / защита картера / Motorschutz          | 1  |
| 2. Põhjakaitse / skid plate / защита картера / Motorschutz          | 1  |
| 3. Tala / support / переклад / Unterstützung                        | 1  |
| 4. Toru / pipe / труба / Rohr                                       | 1  |
| 5. Kronstein / bracket / кронштейн / Konsole                        | 1  |
| 6. Kronstein / bracket / кронштейн / Konsole                        | 1  |
| 7. Kronstein / bracket / кронштейн / Konsole                        | 2  |
| 8. Kronstein / bracket / кронштейн / Konsole                        | 2  |
| 9. Puks / bushing / букса / Buchse                                  | 2  |
| 10. Puks / bushing / букса / Buchse                                 | 2  |
| 11. T-polt / T-bolt / T-болт / T-bolzen                             | 2  |
| 12. T-polt / T-bolt / T-болт / T-bolzen                             | 2  |
| 13. Polt / bolt / болт / Bolzen M10x35                              | 4  |
| 14. Polt / bolt / болт / Bolzen M10x25 DIN7380-galZn                | 4  |
| 15. Polt / bolt / болт / Bolzen M10x25 DIN933-galZn                 | 2  |
| 16. Polt / bolt / болт / Bolzen M8x25                               | 4  |
| 17. Polt / bolt / болт / Bolzen M10x50                              | 2  |
| 18. Mutter / nut / гайка / Mutter M10 DIN934-galZn                  | 6  |
| 19. Mutter / nut / гайка / Mutter M8                                | 2  |
| 20. Mutter / nut / гайка / Mutter M10 DIN985-galZn                  | 6  |
| 21. Seib / washer / шайба / Scheibe 10,5x20x2                       | 16 |
| 22. Seib / washer / шайба / Scheibe 10,5x30x2,5                     | 10 |
| 23. Seib / washer / шайба / Scheibe 8,4x24x2                        | 4  |
| 24. Vedruseib / spring washer / пружинная шайба / Federnscheibe A8  | 6  |
| 25. Vedruseib / spring washer / пружинная шайба / Federnscheibe A10 | 8  |

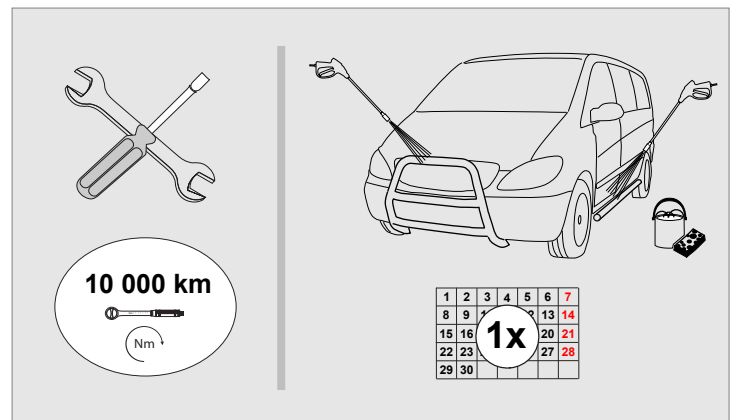
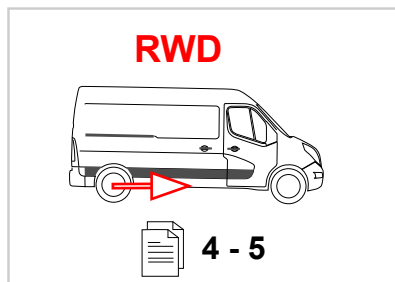
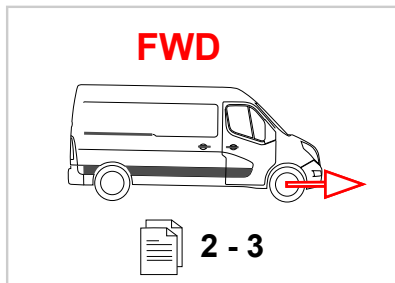

Kaal / Weight / Масса / Gewicht: 17,1 kg

Paigaldusaeg / Time of mounting / Время установки / Einbauzeit: 60 min

Vajalikud tööriistad / Required Tools / Необходимые инструменты / Benötigte Werkzeuge



**M8 - 25 Nm**  
**M10 - 50 Nm**

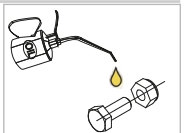

Põhjakaitse paigaldamine esiveolisele mudelile | Installing the skid plate to a front-wheel drive model | Установка защиты картера на модель с передним приводом | Kurbelgehäuse-Schutz bei einem Modell mit Frontantrieb einbauen

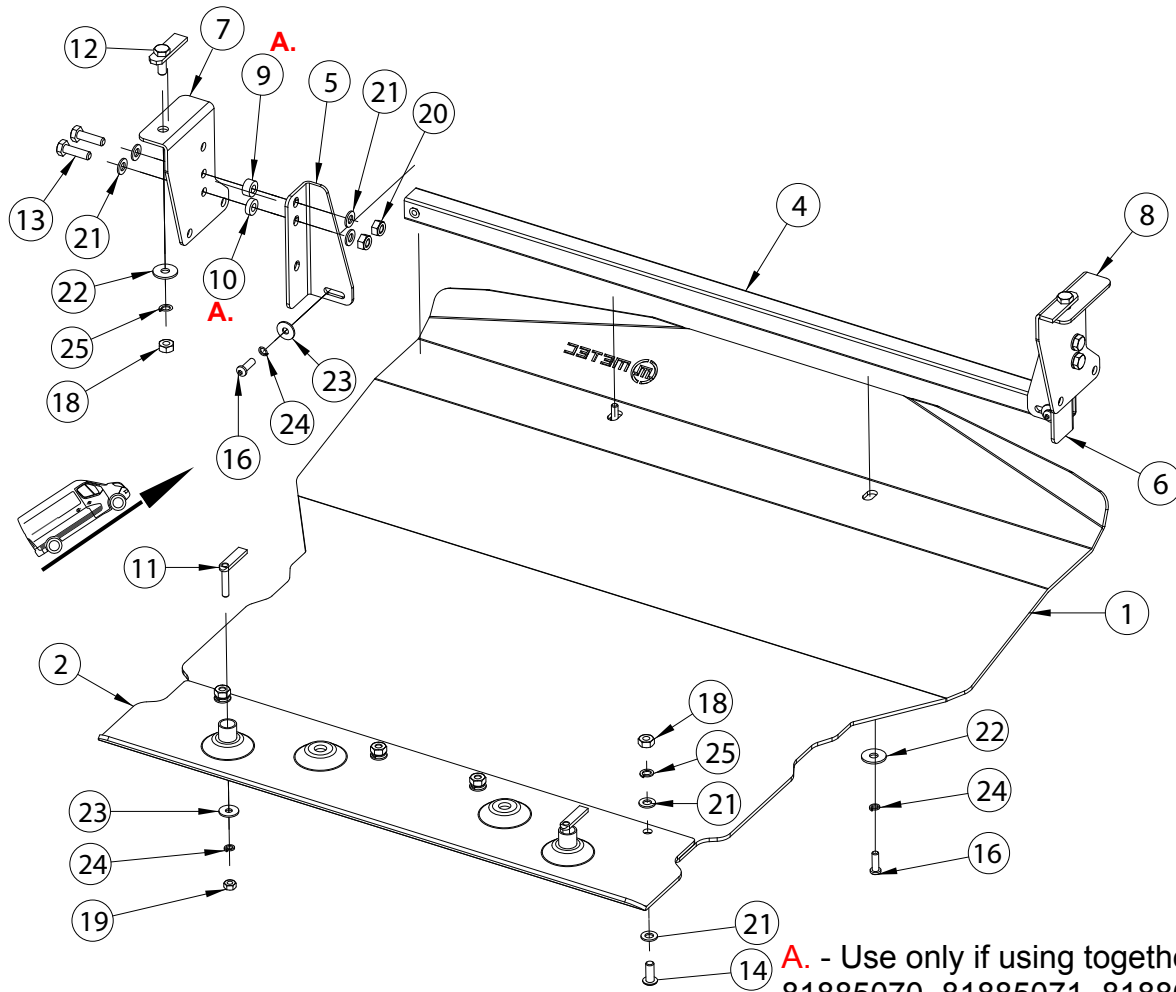

A. - Use only if using together with METEC products 81885070, 81885071, 818860, 818855, 818854

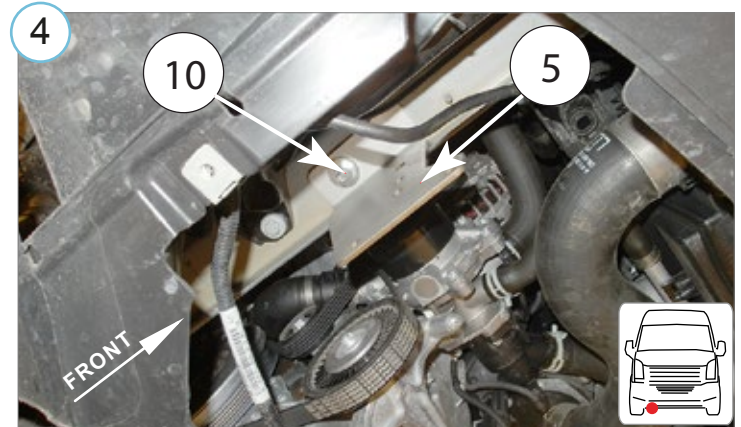
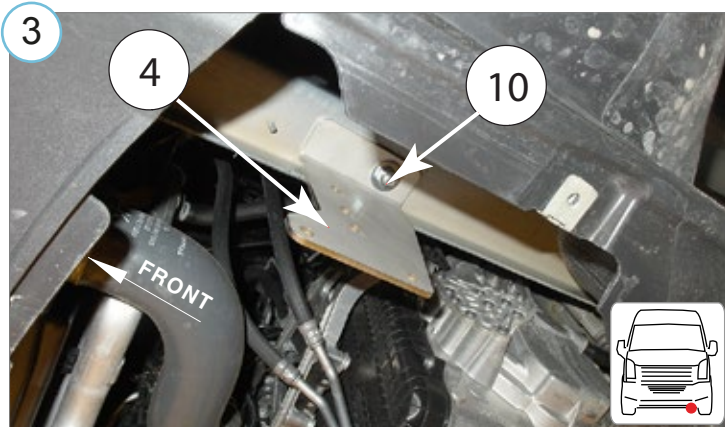
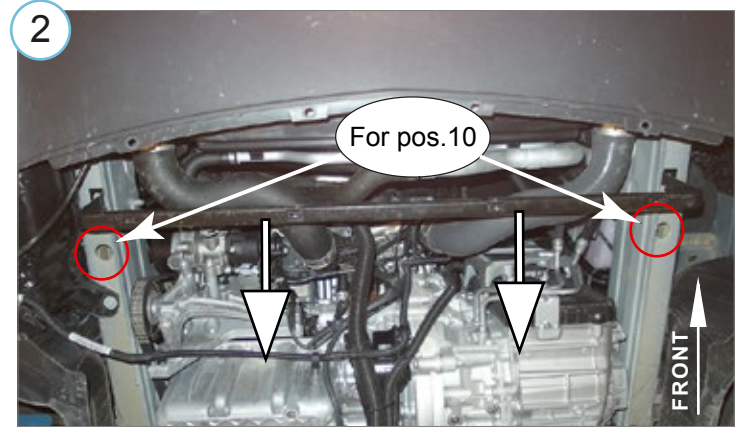
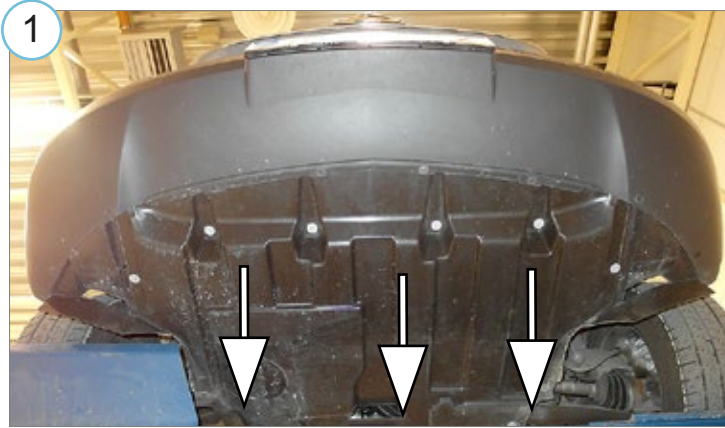



Põhjakaitse paigaldamine esiveolisele mudelile | Installing the skid plate to a front-wheel drive model | Установка защиты картера на модель с передним приводом | Kurbelgehäuse-Schutz bei einem Modell mit Frontantrieb einbauen

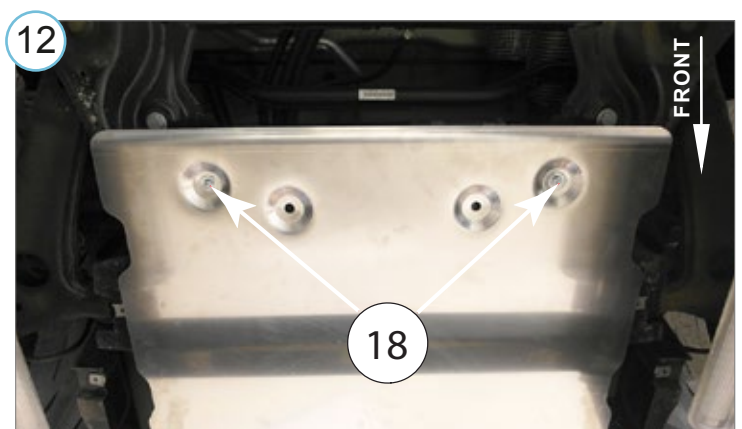
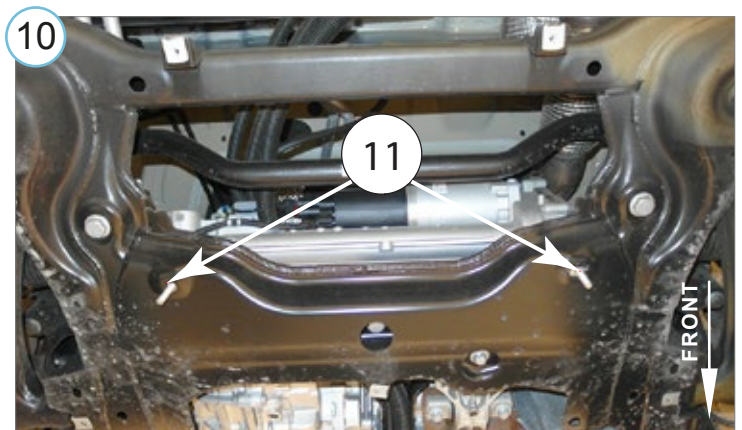
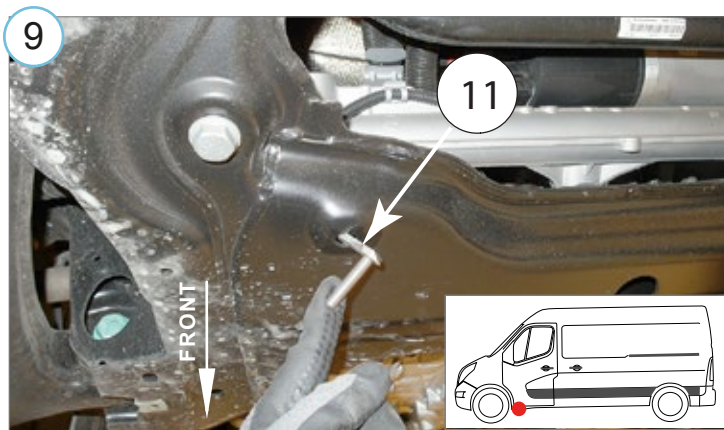
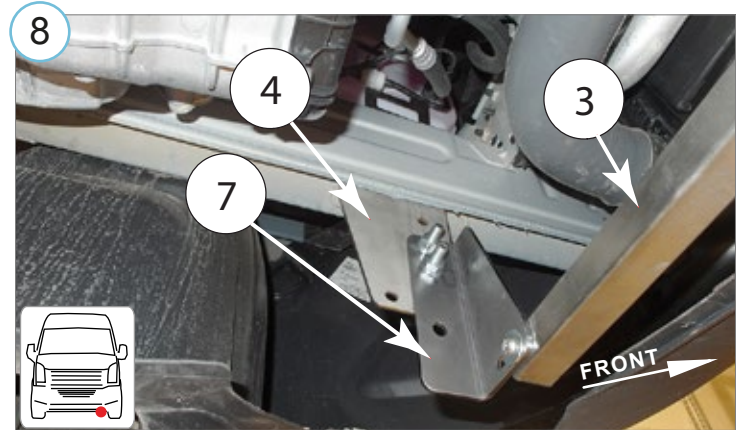
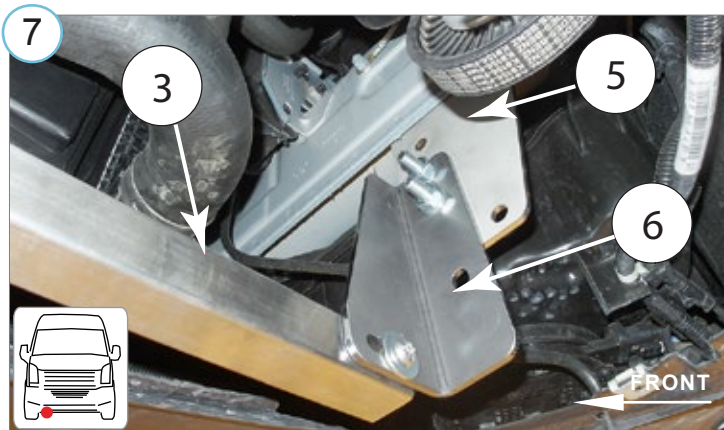
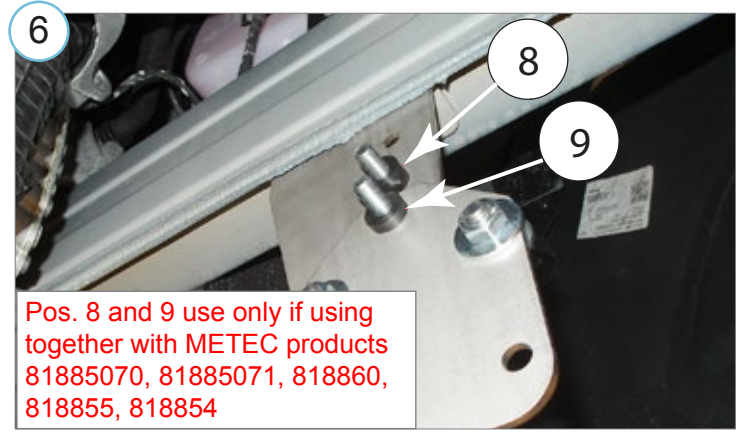
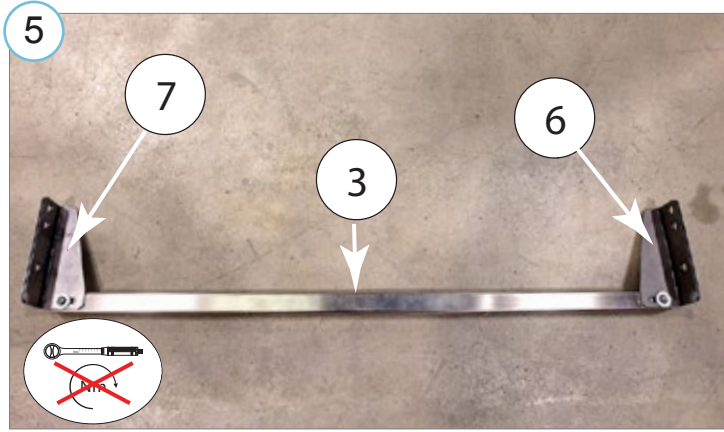



Põhjakaitse paigaldamine tagaveolisele mudelile | Installing the skid plate to a rear-wheel drive model | Установка защиты картера на модель с задним приводом | Kurbelgehäuse-Schutz bei einem Modell mit Hinterradantrieb einbauen

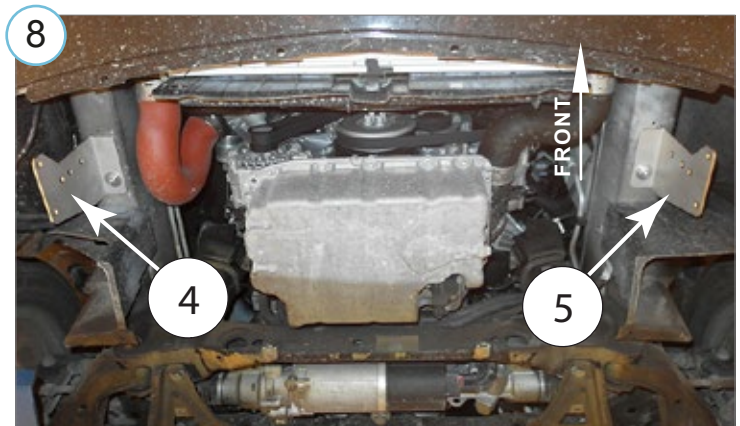
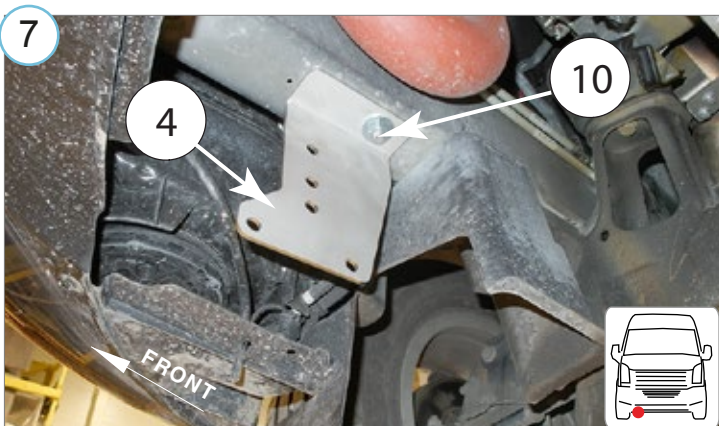
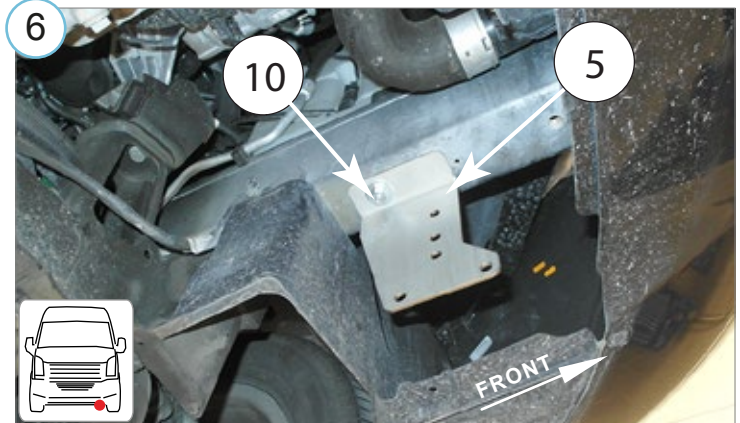
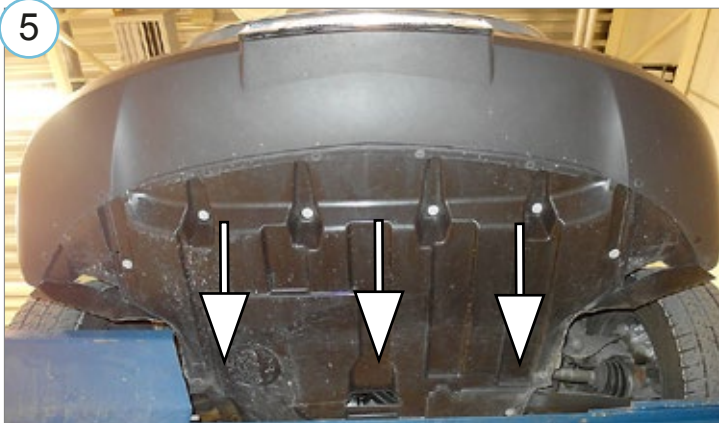
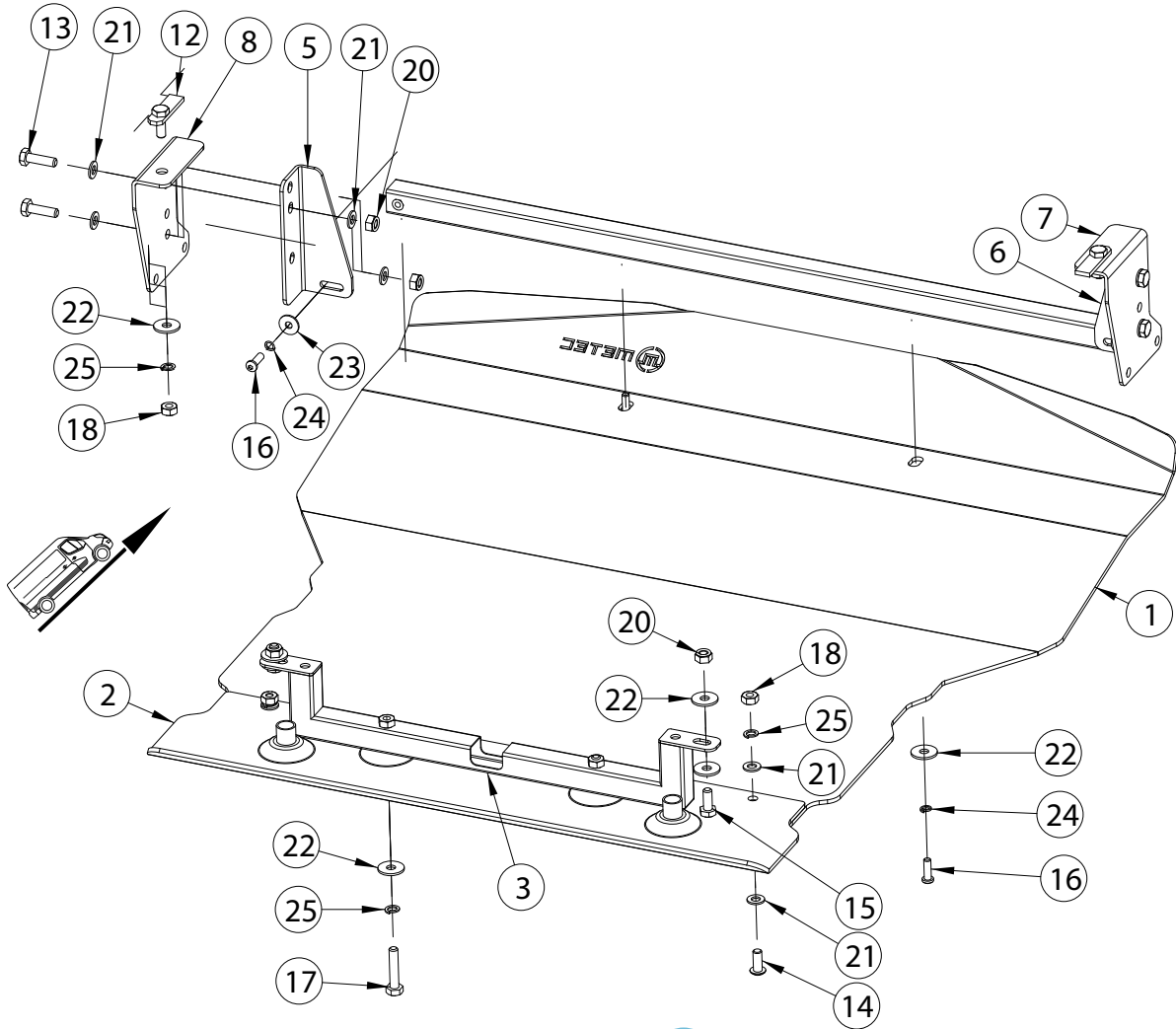



Põhjakaitse paigaldamine tagaveolisele mudelile | Installing the skid plate to a rear-wheel drive model | Установка защиты картера на модель с задним приводом | Kurbelgehäuse-Schutz bei einem Modell mit Hinterradantrieb einbauen

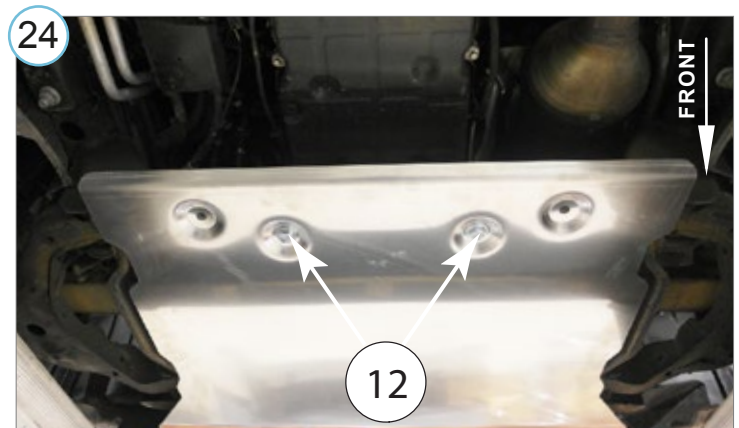
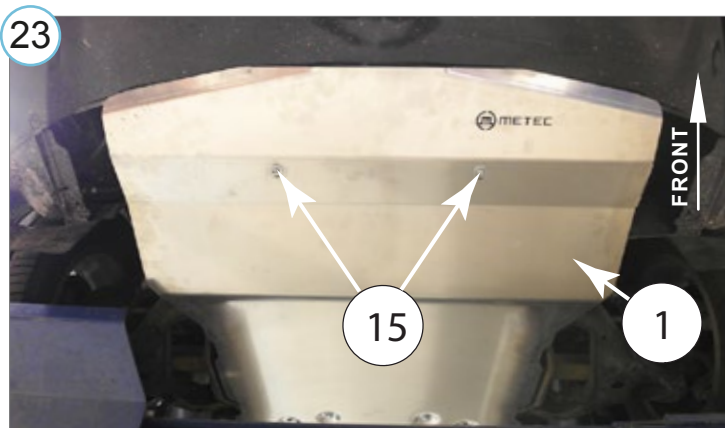
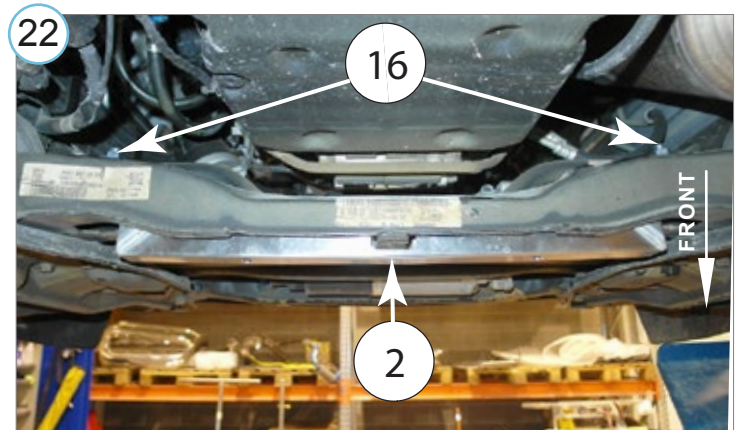
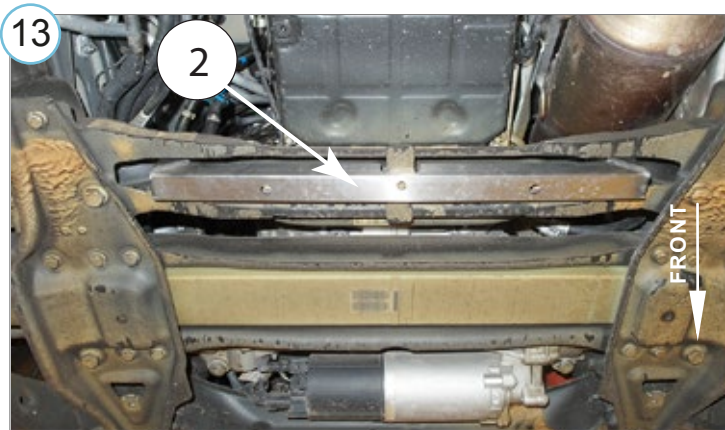
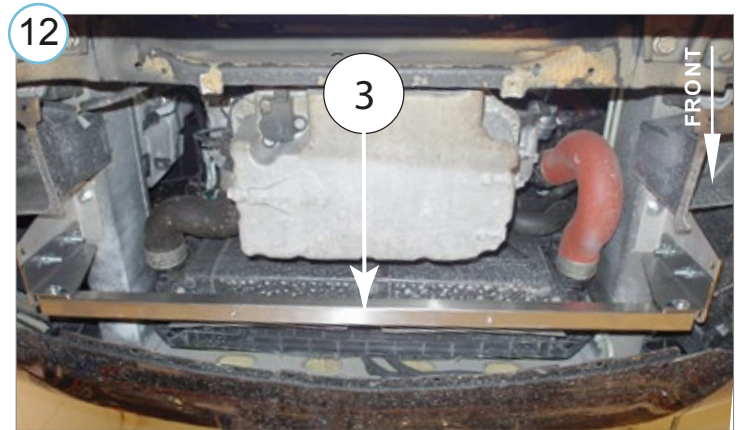
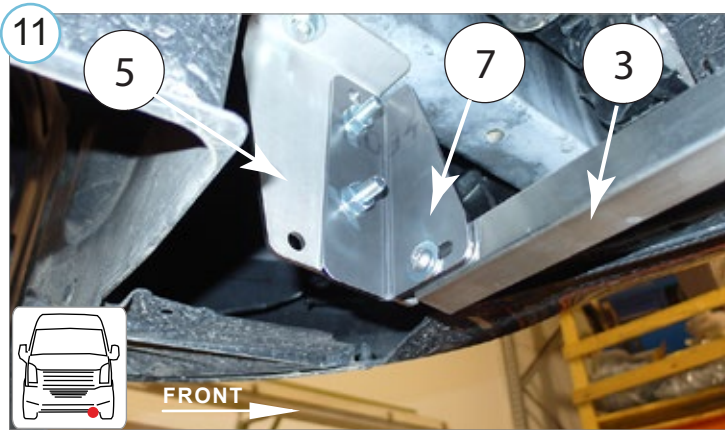
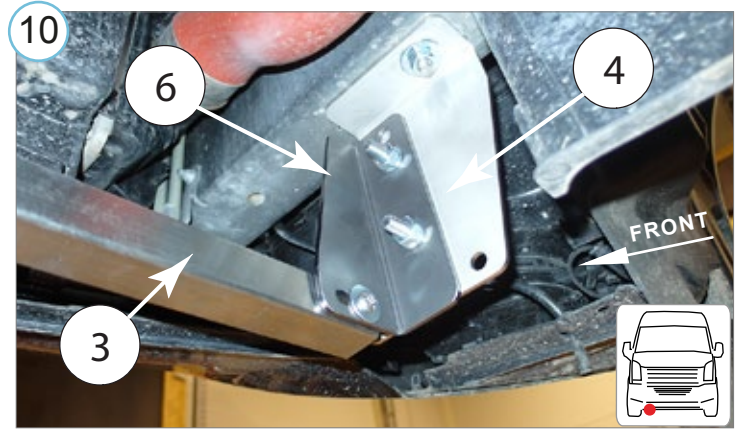
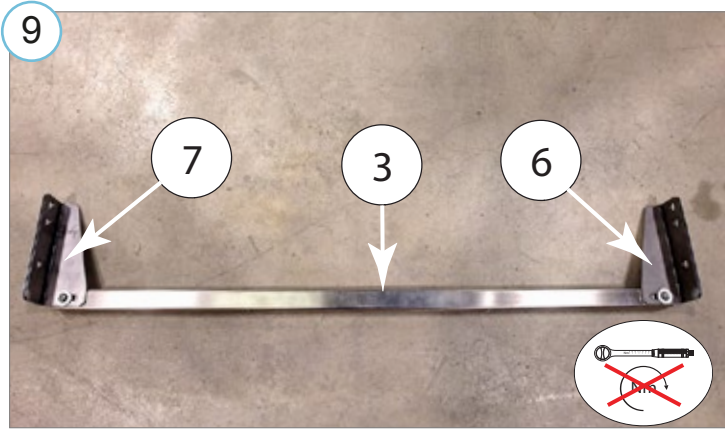

- Kui METEC toode ei vasta Teie ootustele või kui on tegemist toote ebapiisava kvaliteediga, siis pretensioonid esitada lehel [www.metec.ee](http://www.metec.ee)
- If the METEC product does not meet Your expectations or if it is a product of insufficient quality, then you can submit a claim at [www.metec.ee](http://www.metec.ee)
- Если METEC продукт не соответствует Вашим ожиданиям или это продукт недостаточного качества, то претензию предъявить можно на сайте [www.metec.ee](http://www.metec.ee)
- Wenn METEC Produkt nicht Ihren Erwartungen entspricht oder wenn es um Qualitätsmängel geht, dann bitte die Ansprüche auf Seite [www.metec.ee](http://www.metec.ee) einreichen